

DESCRIPTION

- Hawaii series one bowl sink
- SS.304 construction with Brush
- Thickness :1.0 mm
- One-stamping , Laser MOEN logo
- One kitchen faucet hole , one soap dispenser hole as indicated
- Cutout size : Top mounting: 690x430xR12mm
Under mounting:677x417xR41mm
- SoundsShield system
- mounting hardware included

STANDARD

- Comply with QB/T 4013-2010

WARRANTY

- 5 years limited warranty against leaks and drips
- 1 year limited warranty for sink accessories

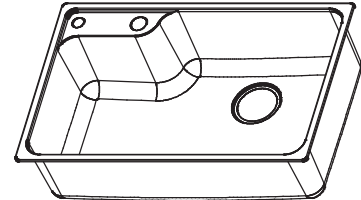

Hawaii
Stainless steel single bowl sink
Models: 29017SLECP
28017SL
28012SL

Units : mm

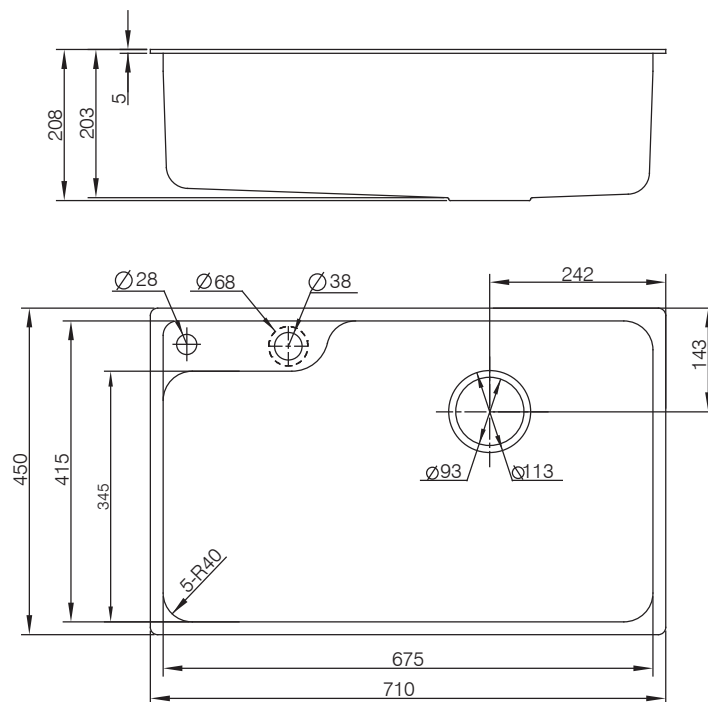

CRITICAL DIMENSION

(DO NOT SCALE)