

DESCRIPTION

- Blade series dual bowl sink
- SS.304 construction with Brush finish
- Thickness :1.0 mm
- One-stamping , Laser MOEN logo
- One kitchen faucet hole , one soap dispenser hole as indicated
- SB031,40mm Drainage pipe ,G1-1/2 connection
- SB18 Drainer , G1-1/2 connection
- Cutout size : Top mounting :806x436xR15mm
Under mounting:790x420xR10mm
- SoundsShield system
- Mounting hardware included

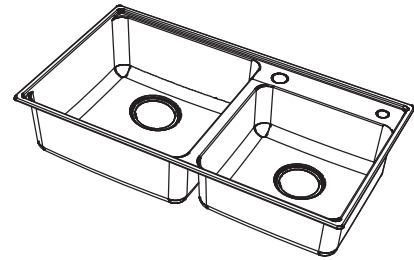

Blade
Stainless steel dual bowl sink
Models: 27604SL

STANDARD

- Comply with QB/T 4013-2010

WARRANTY

- 5 years limited warranty against leaks and drips
- 1 year limited warranty for sink accessories

Units : mm

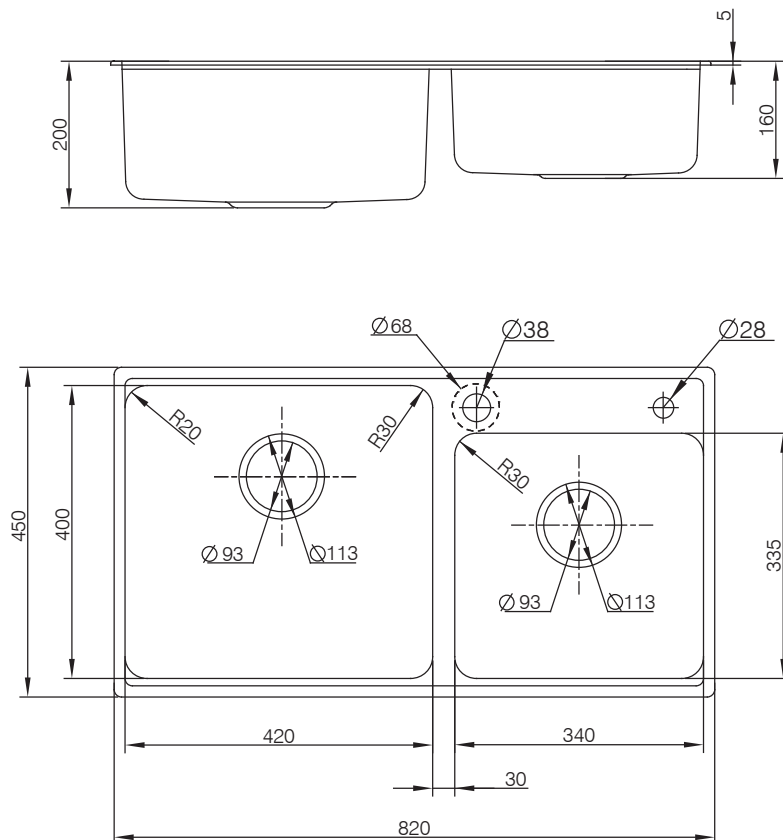

CRITICAL DIMENSION

(DO NOT SCALE)